

CIRCUIT DIAGRAM

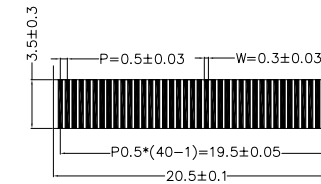
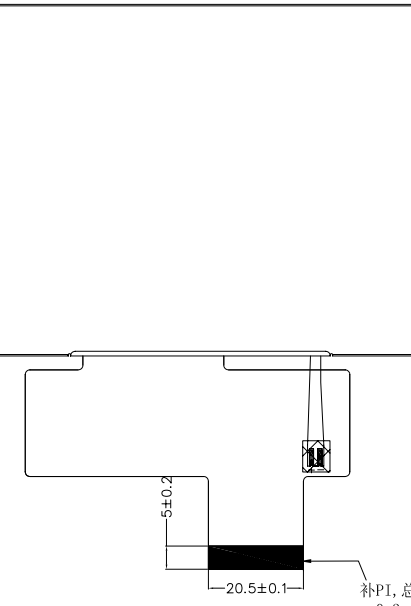

DETAIL "A" (S=3:1)

| PIN FUCTION | |
|-------------|---------|
| PIN | SYMBOL |
| 1 | VLED- |
| 2 | VLED+ |
| 3 | GND |
| 4 | VDD |
| 5 | R0 |
| 6 | R1 |
| 7 | R2 |
| 8 | R3 |
| 9 | R4 |
| 10 | R5 |
| 11 | R6 |
| 12 | R7 |
| 13 | G0 |
| 14 | G1 |
| 15 | G2 |
| 16 | G3 |
| 17 | G4 |
| 18 | G5 |
| 19 | G6 |
| 20 | G7 |
| 21 | B0 |
| 22 | B1 |
| 23 | B2 |
| 24 | B3 |
| 25 | B4 |
| 26 | B5 |
| 27 | B6 |
| 28 | B7 |
| 29 | GND |
| 30 | CLKIN |
| 31 | STBYB |
| 32 | HSD |
| 33 | VSD |
| 34 | DEN |
| 35 | NC |
| 36 | GND |
| 37 | XR(NC) |
| 38 | YD(NC) |
| 39 | XL(NC) |
| 40 | YUC(NC) |

NOTES:

1. DISPLAY TYPE: TFT, TRANSMISSIVE, NORMALLY WHITE
2. OPERATION VOLTAGE: VDD=3.3V
3. VIEWING DIRECTION: 12 O'CLOCK.
4. IC DRIVER: HX8664B+HX8264D
5. OPERATING TEMP: -20°C ~ 70°C.
6. STORAGE TEMP: -30°C ~ 80°C.
7. LED BACKLIGHT: 12-LED WHITE.
8. GENERAL TOLERANCE: ±0.2.
9. RoHS COMPLIANT.

| | | | |
|--------------------------------|---------|------------|----------|
| CUSTOMER APVL | | DATE | |
| DRAWN | SCALE | TITLE | |
| DFTG CHK | UNIT mm | MI0500PT-7 | |
| ENGR CHK | | MODEL | |
| APPROVAL | | | |
| MULTI-INNO TECHNOLOGY CO.,LTD. | | DWG NO | PAGE 1/1 |